

# HPLW-LED

## Construction:

- Steel housing, chassis and shield

## Light Source:

- LED
- Dimming to 10% **Included**

## Notes:

- Center lockup – hardware include
- ADA Compliant
- UL and CUL listed **WET** location
- LED Components
  - Replaceable Module
  - CRI > 90
  - Universal 120/277 volt standard
  - 5-Year Warranty on LED Components

Type:	
Job Name:	

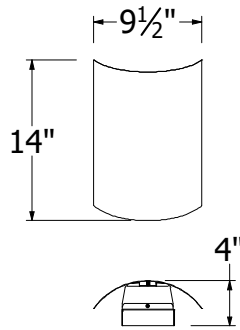

### HPLW-14

Height - 14"  
Width - 9 1/2"  
Depth - 4"



## ORDERING INFORMATION

Example: HPLW-14-LED-O2A-3-W1

### HPLW

Size	LED					Kelvin	Cage	Finish	Diffuser	Options
		Watts	Source Lumens	Dimming	Energy Star					
14-LED	O2A	12	1600	0-10v	NO	2 3000K 3 3500K 4 4000K		<b>B1</b> Satin Black <b>B2</b> Text Black <b>Z1</b> Satin Bronze <b>Z3</b> Text Bronze <b>W1</b> Yolk White <b>W2</b> Gloss White <b>T4</b> Shimmer Gray <b>M13</b> Anod Silver <b>T6</b> Pewter <b>W13</b> Pearl Beige  <b>Optional</b> (See Price List) <b>M17</b> Brass Powder <b>P2</b> Brushed Alum <b>P9</b> Brushed Nickel	None - steel shield	<b>DIM</b> LED dimming driver (0 - 10v)



28435 Industry Drive., Valencia, California 91355  
 West Coast Sales: 800-325-4448 / 661-257-0286 • fax 800-323-2346 / 661-257-0201  
 East Coast Sales: 866-350-0991 • fax 866-490-5754  
 www.lightwayind.com • sales@lightwayind.com

