

## Notes:

- Round, steel, seamless, Wall thickness - 14-gauge (.065")
- Nominal dimensions:
- O.D. - 3.04"
- I.D. - 2.88"
- Available in 8', 10', 12' and custom lengths
- Flange Bases
- 1/4" steel plate with slots for anchor bolts
- Round - 9" diameter (3 anchor bolt attachment)
- Square - 9" square (4 anchor bolt attachment)
- **Decorative Covers** (Optional)
- Steel decorative covers attach to flange base (round or square)
- **Anchor Bolt Set** (Optional)
- Consists of hex nut, washer and anchor bolt (3/8" diameter X 9 1/2" long with 1 1/4" thread)
- **Hand Hole** (Optional)
- For flange base attachment only, hand hole is 12" above base with gasket and cover
- **Installation** (consult local building code)
- Direct burial - typically 2-feet set in concrete
- Flange base - mounts to concrete footing
- Templates - consult factory

Type:	
Job Name:	

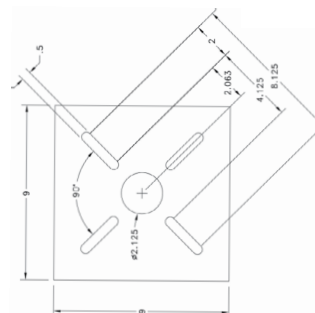
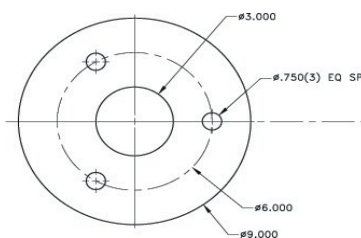
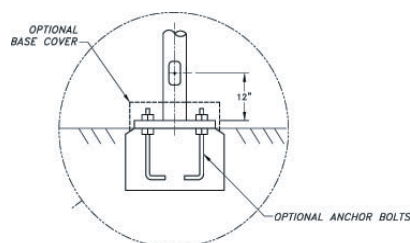

## ORDERING INFORMATION

	Description	Direct Buried	Anchor Bolts	Base Cover	Finish	Options
-81	10 foot pole round, 3 inch OD steel	Yes	N/A	N/A	B1 Satin Black	-BH Bullhead
-82	12 foot pole round, 3 inch OD steel	Yes	N/A	N/A	Z3 Textured Bronze	-88 Base Cover
-193	15 foot pole round, 3 inch OD steel	Yes	N/A	N/A	Optional See color chart (Consult Factory for Pricing)	-89 Set of 3 anchor bolts -90 Set of 4 anchor bolts
-86	8 foot pole round, 3 inch OD, steel with 9 inch round base	No	3	RD		Optional (Consult factory for pricing)
-91	10 foot pole round, 3 inch OD, steel with 9 inch round base	No	3	RD		
-194	12 foot pole round, 3 inch OD, steel with 9 inch round base	No	3	RD		
-87	8 foot pole round, 3 inch OD, steel with 9 inch square base	No	4	SQ		-99 Custom length, diameter or configuration
-92	10 foot pole round, 3 inch OD, steel with 9 inch square base	No	4	SQ		
-195	12 foot pole round, 3 inch OD, steel with 9 inch square base	No	4	SQ		

