

GHCW-LED

Construction:

- Fade and Rust Resistant Polycarbonate Construction
- Glare Free Frosted Acrylic Lens

Light Source:

- LED
- Incandescent Medium Base / Lamp by others

Notes:

- Mounts to standard junction box
- Mounting hardware included
- Optional Photocell
- UL and CUL listed **WET** location
- LED Components
 - Replaceable Module
 - CRI > 80
 - 120 volt standard
 - 5-Year Warranty on LED Components

Type:	
Job Name:	

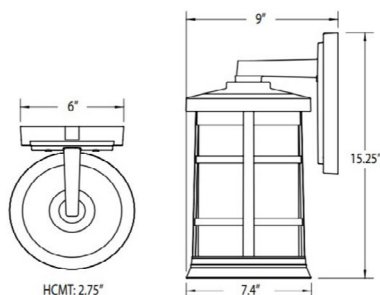

ORDERING INFORMATION

Example: **GHCW-15-LED-A-13W-4-Z99-FSA**

Model	Cage	Voltage	Lamping	Kelvin	Finish	Diffuser	Options
GHCW-15-LED		A 120 Volt	13w LED / 1140lm E26 Medium Base (NL)	2 3000K 4 4000K	B99 Black W99 White Z99 Bronze	FSA Frosted Smooth Acrylic	21-01 Photocell - 120 Volt



28435 Industry Drive., Valencia, California 91355
 West Coast Sales: 800-325-4448 / 661-257-0286 • fax 800-323-2346 / 661-257-0201
 East Coast Sales: 866-350-0991 • fax 866-490-5754
 www.lightwayind.com • sales@lightwayind.com



Revision: 07/05/2019