

# BLCW Series



B1 Satin Black



B2 Textured Black



M13 Anodized Silver



T6 Pewter



P9 Brushed Nickel



W13 Pearl Beige



W1 York White



Z1 Satin Bronze



Z3 Textured Bronze



T4 Shimmer Gray



P2 Brushed Aluminum



W3 Textured White



W2 Gloss White



28435 Industry Drive., Valencia, California 91355  
West Coast Sales: 800-325-4448 /661-257-0286 • fax 800-323-2346 /661-257-0201  
East Coast Sales: 866-350-0991 • fax 866-490-5754  
www.lightwayind.com • sales@lightwayind.com



Revision: 10/28/2022

# BLCW-LED

## Construction:

- Steel housing and chassis
- Diffused LED Arrays

## Light Source:

- LED
- Dimming to 10% **Included**

## Notes:

- Indirect Wall Wash Lighting with edge light
- ADA Compliant
- Universal Mounting to Standard J-Box
- UL and CUL listed **DAMP** location
- LED Components
  - Replaceable Module
  - CRI > 90
  - Universal 120/277 volt standard
  - 5-Year Warranty on LED Components

Type:	
Job Name:	



### BLCW-24-LED

- A - 24"
- B - 2.5"
- C - 3"
- D - 4.5"
- E - 4.5"
- F - 9.5"\*

\*From Bottom

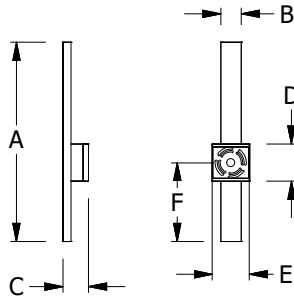

## ORDERING INFORMATION

Example: BLCW-24-LED-O3A-4-B1

### BLCW

Size	LED					Kelvin	Cage	Finish	Diffuser	Options
		Watts	Source Lumens	Dimming	Energy Star	2 3000K 3 3500K 4 4000K		<b>B1</b> Satin Black <b>B2</b> Text Black <b>M13</b> Anod Silver <b>T4</b> Shimmer Gray <b>T6</b> Pewter <b>W1</b> Yolk <b>W2</b> Gloss White <b>W3</b> Text White <b>W13</b> Pearl Beige <b>Z1</b> Satin Bronze <b>Z3</b> Text Bronze  <b>Optional</b> (See Price List) <b>P2</b> Brushed Alum <b>P9</b> Brushed Nickel		<b>DIM</b> LED dimming driver (0 - 10v) Dimming to 10% <b>(Included)</b>
24-LED	O3A	18	2400	0-10v	NO					



28435 Industry Drive., Valencia, California 91355  
 West Coast Sales: 800-325-4448 / 661-257-0286 • fax 800-323-2346 / 661-257-0201  
 East Coast Sales: 866-350-0991 • fax 866-490-5754  
 www.lightwayind.com • sales@lightwayind.com

