

VHAW-LED

Construction:

- Steel housing and chassis
- Diffuser is clear or white prismatic polycarbonate

Light Source:

- LED
- Dimming to 10% **Included**

Notes:

- Bi-directional keyhole slots left and right
- Optional knockouts (KO) top and bottom
- Optional photocell - option 21 (specify voltage)
- Optional battery backup - Increases depth to 6 5/8"
- UL and CUL listed **WET** location
- LED Components
 - Replaceable Module
 - CRI > 90
 - Universal 120/277 volt standard
 - 5-Year Warranty on LED Components

Type:	
Job Name:	

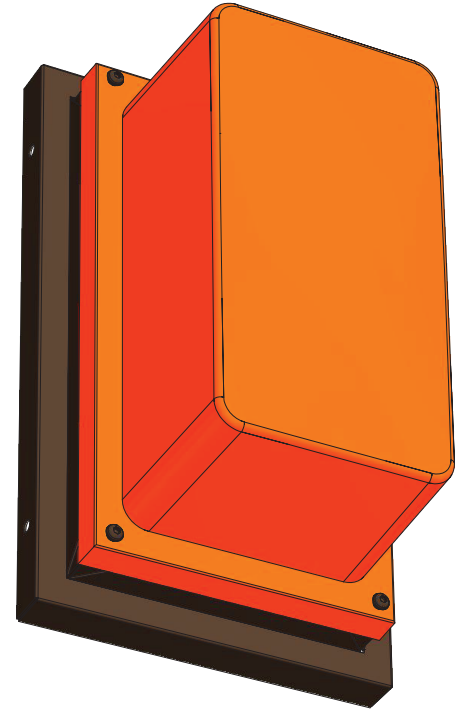

VHAW-11

Height - 10 1/4"
Width - 6"
Depth - 4 7/8"

VHAW-11 w/BB

Height - 10 1/4"
Width - 6"
Depth - 6 5/8"



ORDERING INFORMATION

Example: VHAW-11-LED-O2A-AMBER-Z1-CPP

VHAW

Size	LED					Kelvin	Cage	Finish	Diffuser	Options
		Watts	Source Lumens	Dimming	Energy Star	AMBER		B1 Satin Black B2 Text Black Z1 Satin Bronze Z3 Text Bronze W1 Yolk White W2 Gloss White T4 Shimmer Gray M13 Anod Silver T6 Pewter W13 Pearl Beige Optional (See Price List) M17 Brass Powder M16 Antique Brass P2 Brushed Alum	CPP Clear Prismatic Polycarbonate Optional Lens Material (See Price List) WPP White Prismatic Polycarbonate	DIM LED dimming driver (0 - 10v) 42 All Aluminum Construction 21 Photocell - <i>See Notes</i> -01 120 volt -02 277 volt KO Knockouts (See Notes) Optional Voltage -347V Input voltage to 347v Battery Backup Options (Available with 0-10v only) BB10 10 Watts (1170lm) for 90-Minutes
11-LED	O1A	6	800	0-10v	NO					
	O2A	12	1600	0-10v	NO					



28435 Industry Drive., Valencia, California 91355
 West Coast Sales: 800-325-4448 / 661-257-0286 • fax 800-323-2346 / 661-257-0201
 East Coast Sales: 866-350-0991 • fax 866-490-5754
 www.lightwayind.com • sales@lightwayind.com

